

**PROGRESS®**

Est. 1931

**VEGA**

**2-SLICE TOASTER**

Instruction manual

Please read all of the instructions carefully and retain for future reference.

## Safety Instructions

When using electrical appliances, basic safety precautions should always be followed.

Check that the voltage indicated on the rating plate corresponds with that of the local network before connecting the appliance to the mains power supply.

Children aged from 8 years and people with reduced physical, sensory or mental capabilities or lack of experience and knowledge can use this appliance, only if they have been given supervision or instruction concerning use of the appliance in a safe way and understand the hazards involved.

Children should be supervised to ensure that they do not play with the appliance.

Unless they are older than 8 and supervised, children should not perform cleaning or user maintenance.

This appliance is not a toy.

This appliance contains no user serviceable parts. If the supply cord, plug or any part of the appliance is malfunctioning, or if it has been dropped or damaged, only a qualified electrician should carry out repairs. Improper repairs may place the user at risk of harm.

Keep the appliance and its power supply cord out of the reach of children.

Do not immerse the electrical components of this appliance in water or any other liquid.

Do not leave the appliance unattended whilst connected to the mains power supply.

Use of an extension cord with the appliance is not recommended.

This appliance should not be operated by means of an external timer or separate remote control system.

This appliance is intended for domestic use only. It should not be used for commercial purposes.

If this appliance falls or accidentally becomes immersed in water, unplug it from the wall outlet immediately. Do not reach into the water.



**Caution:** Hot surface – do not touch the hot section or heating components of the appliance.

Take care not to pour water on the heating element.

Do not toast pastries with runny fillings or frosting.

Do not toast torn slices of bread.

**Warning:** Keep the appliance away from flammable materials.

### Care and Maintenance

**STEP 1:** Before attempting any cleaning or maintenance, unplug the toaster from the mains power supply and allow to fully cool.

**STEP 2:** Wipe the toaster housing with a soft, damp cloth and dry thoroughly.

**STEP 3:** Remove crumbs from inside the base of the toaster by sliding open the crumb tray.

Do not immerse the toaster in water or any other liquid.

Never use harsh or abrasive cleaning detergents or scourers to clean the toaster, as this could damage the surface.

**Caution:** Never place fingers near or inside the toasting slots.

Always unplug the toaster and allow it to cool thoroughly before attempting to remove any bread that has become stuck inside the toasting slot.

Take care when removing food from the toasting slot to avoid damage to the internal mechanism and heating element.

Do not allow crumbs to build up inside the base of the toaster. Empty the crumb tray periodically.

Do not operate the toaster without bread, as this may cause damage to the toaster.

# PROGRESS®

Est. 1931

## Description of Parts

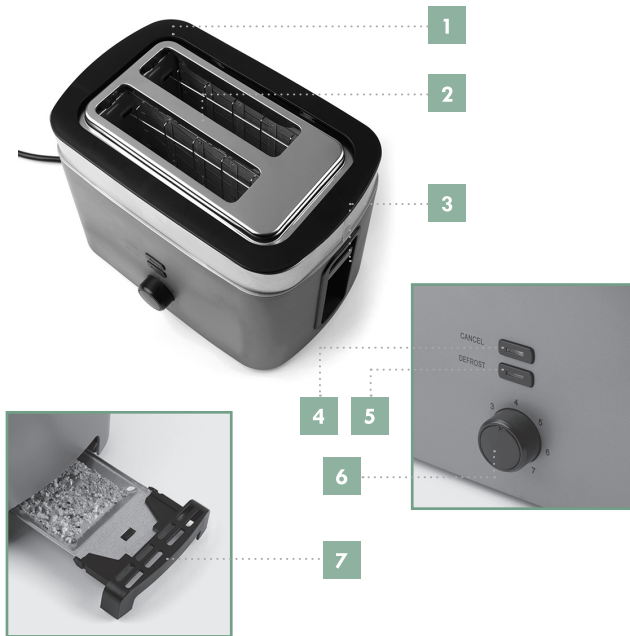

1. Toaster housing
2. Toasting slot(s)
3. Loading lever
4. Cancel button

5. Defrost button
6. Browning control dial
7. Removable crumb tray

## Before First Use

Before using the toaster for the first time, wipe the toaster housing with a soft, damp cloth and dry thoroughly.

Do not immerse the toaster in water or any other liquid.

**Note:** When using toaster for the first time, a slight smoke or odour may be emitted. This is normal and will soon subside. Allow for sufficient ventilation around the toaster.

## Using the Vega 2-Slice Toaster

**STEP 1:** Place the toaster onto a flat, stable surface at a height that is comfortable for the user.

**STEP 2:** Plug in and switch on the toaster at the mains power supply.

**STEP 3:** Turn the browning control dial to the desired setting. Select '3–4' for medium brown toast.

**STEP 4:** Insert the bread or toasting food into the toasting slot(s) and lower the toasting lever until it is locked into place. Toasting will begin when the lever is fully down.

**STEP 5:** When the toast reaches the desired browning level, the toast will pop up automatically.

**STEP 6:** Turn the toaster off and unplug it from the mains power supply.

**STEP 7:** Remove the toast and any crumbs from the toasting slot(s) using heat-resistant gloves.

**Note:** To interrupt toasting mid-setting, press the 'Cancel' button

**Caution:** Never use a fork or sharp-edged utensil to remove toast, as this may damage the heating element or cause injury.

## Using the Defrost Setting

Insert the frozen bread into the toasting slot(s) and lower the toasting lever until it is locked into position. When toasting has begun, press the 'Defrost' button which will illuminate. Defrosting will begin once the lever is fully lowered and the defrost button has been pressed.

## Automatic Centring Guides

Lowering the toasting lever closes the centring guides and holds the bread centrally in the toasting slots.

## Storage

The toaster must be cool, clean and dry before storing in a cool, dry place.

Never wrap the cord tightly around the toaster; wrap it loosely to avoid causing damage.

## Specifications

Product code: EK3215

Input: 220–240 V ~ 50/60 Hz

Output: 780–930 W

The crossed out wheelie bin symbol on this item indicates that this appliance needs to be disposed of in an environmentally friendly way when it becomes of no further use or has worn out.

Contact your local authority for details of where to take the item for recycling.



# **PROGRESS®**

Est. 1931

Manufactured/imported by:  
UP Global Sourcing UK Ltd.,  
Edmund-Rumpler- Strabe 5 51149 Koln.  
**MADE IN CHINA.**



CD010420/MD000000/V2