

PROGRESS®

Est. 1931

**3 IN 1 ELECTRIC
FOOD GRINDER**

Instruction manual

PROGRESS®

Est. 1931

Please read all of the instructions carefully and retain for future reference.

Safety Instructions

When using electrical appliances, basic safety precautions should always be followed.

Check that the voltage indicated on the rating plate corresponds with that of the local network before connecting the appliance to the mains power supply.

Children aged from 8 years and people with reduced physical, sensory or mental capabilities or lack of experience and knowledge can use this appliance, only if they have been given supervision or instruction concerning use of the appliance in a safe way and understand the hazards involved.

Children should be supervised to ensure that they do not play with the appliance.

Unless they are older than 8 and supervised, children should not perform cleaning or user maintenance.

This appliance is not a toy.

This appliance contains no user serviceable parts. If the power supply cord, plug or any part of the appliance is malfunctioning, or if the appliance has been dropped or damaged, only a qualified electrician should carry out repairs. Improper repairs may place the user at risk of harm.

Keep the appliance and its power supply cord out of the reach of children.

Keep the appliance out of the reach of children when it is switched on or plugged in.

Keep the appliance and its power supply cord away from heat or sharp edges that could cause damage.

Keep the appliance away from other heat emitting appliances.

Keep hands, fingers, hair and any loose clothing away from the rotating tools of the appliance.

Do not immerse the electrical components of this appliance in water or any other liquid.

Do not operate the appliance with wet hands.

Do not leave the appliance unattended whilst connected to the mains power supply.

Do not remove the appliance from the mains power supply by pulling the cord; switch it off and remove the plug by hand.

Do not pull or carry the appliance by its power supply cord.

Do not allow the power supply cord to hang over worktops, touch hot surfaces or become twisted.

Do not use the appliance if it has been dropped, if there are visible signs of damage or if it is leaking.

Do not use the appliance for anything other than its intended use.

Do not use any accessories other than those supplied.

Do not use any damaged accessories.

Do not use this appliance outdoors.

Do not store the appliance in direct sunlight or in high humidity conditions.

Do not move the appliance whilst it is in use.

Do not touch any moving parts on this appliance during use, as this could cause injury.

Do not put fingers near the blade while it is in operation.

Do not use broken or loose cutting or rotating blades.

Switch off the appliance and disconnect it from the mains power supply before changing or fitting accessories.

Always unplug the appliance after use and before any cleaning or user maintenance.

The cutting blades are sharp, care must be taken when handling or removing the blades for cleaning or user maintenance.

To avoid injury, always use the unit when it is completely assembled and use the pusher when feeding the food into the food grinder.

Never use your hand to push food into the food grinder as this could cause injury, always use the pusher.

Always use the appliance on a flat, stable surface, at a height that is comfortable for the user.

PROGRESS®

Est. 1931

Use of an extension cord with the appliance is not recommended. This appliance should not be operated by means of an external timer or separate remote control system, other than that supplied with this appliance.

This appliance is intended for domestic use only. It should not be used for commercial purposes.

Misuse of the appliance could potentially cause injury to the user.

Warning: Handle the blade with care, as it is extremely sharp. Exercise caution when attaching, removing, cleaning or storing the blade.

Attention: The blade will continue to rotate briefly after the appliance has turned off.

Care and Maintenance

Before attempting any cleaning or maintenance, switch off and unplug the food grinder from the mains power supply and allow it to cool fully. Make sure the power button is at the 'OFF' position.

STEP 1: Wipe the food grinder main unit with a soft, damp cloth and allow to dry thoroughly.

STEP 2: Disassemble the product by following the instructions in the section entitled 'Assembling the 3 in 1 Food Grinder' in reverse. Remove all of the parts.

STEP 3: Clean the parts in warm, soapy water, then rinse and dry thoroughly.

Do not immerse the food grinder main unit in water or any other liquid.

Do not use harsh or abrasive detergents or scourers to clean the food grinder or the blades, as this could cause damage.

The food grinder and its blade are not safe for dishwasher use.

Note: The food grinder should be cleaned after each use.

Warning: Handle the blade with extreme caution, as it is extremely sharp. Exercise caution when attaching, removing, cleaning or storing the blade attachment.

Description of Parts

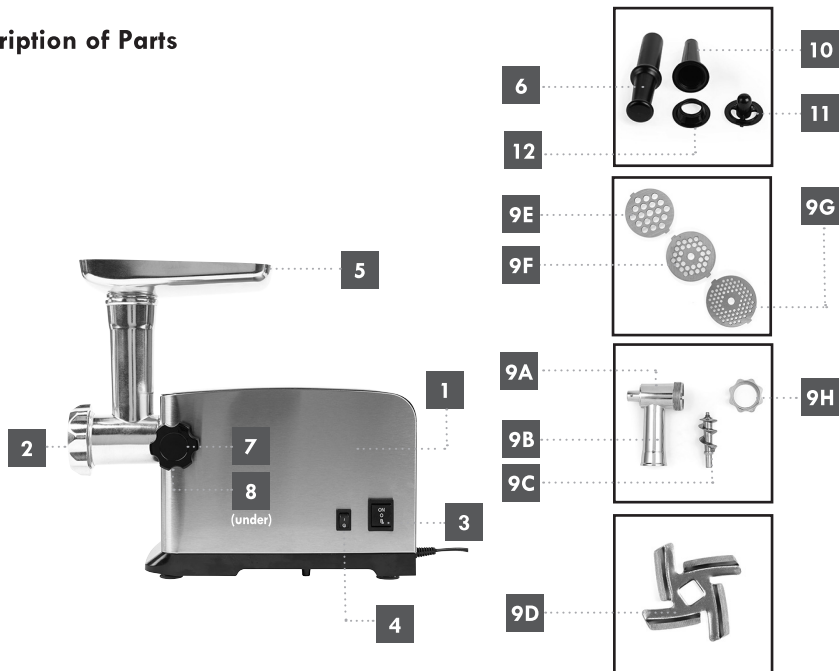

1. 3 in 1 Electric Food Grinder main unit
2. Main unit opening
3. Function button (ON/O/R)
4. Power button (ON/OFF)
5. Hopper plate
6. Pusher
7. Head lock knob
8. Head lock knob opening
- 9a) Grinding head
- 9b) Feeder tube

- 9c) Feed screw
- 9d) Cutting blade
- 9e) Coarse cutting plate (7 mm)
- 9f) Medium cutting plate (5 mm)
- 9g) Fine cutting plate (3 mm)
- 9h) Fixing ring
10. Sausage attachment
11. Kibbeh attachment
12. Ring-shaped flange

Instructions for Use

Before First Use

Clean the food grinder following the instructions in the section entitled 'Care and Maintenance'.

Note: When using the food grinder for the first time, a slight odour may be emitted. This is normal and will soon subside. Allow for sufficient ventilation around the food grinder and only use it for the recommended length of time.

Assembling the 3 in 1 Electric Food Grinder

STEP 1: Position the grinding head into the opening on the food grinder main unit, making sure the tabs on both are aligned.

STEP 2: Insert the head lock knob into the head lock knob opening and turn it in a clockwise direction until it is secured in place.

STEP 3: Insert the feed screw into the grinding head, making sure the feed screw shaft is aligned with the pin on the inside of the grinding head.

STEP 4: Carefully position the square hole on the cutting blade over the square end of the feed screw and push downwards. Make sure the sharpened side of the cutting blade is facing outwards.

STEP 5: Position the desired cutting plate onto the grinding head, making sure the tabs on both are aligned.

STEP 6: Screw the fixing ring firmly into grinding head by turning it in a clockwise direction until it is secure.

STEP 7: Slot the hopper plate onto the feeder tube of the grinding head.

Note: In order to disassemble, follow these steps in reverse.

Warning: The assembly/disassembly of any of the product parts must be performed with the power button in the 'OFF' position and with the food grinder disconnected from the mains power supply.

Using the Sausage Attachment

STEP 1: Unscrew the fixing ring from the assembled grinding head by turning it in an anticlockwise direction and pulling it away from the food grinder main unit.

STEP 2: Position the sausage attachment to the desired cutting plate, making sure that the rims on both are aligned.

STEP 3: Replace the fixing ring onto the grinding head and twist in a clockwise direction until secure.

Using the Kibbeh Attachment

STEP 1: Unscrew the fixing ring from the assembled grinding head by turning it in an anticlockwise direction and pulling it away from the food grinder main unit.

STEP 2: Remove the cutting plate by pulling it away from the food grinder main unit.

STEP 3: Position the kibbeh attachment onto the grinding head, making sure that the tabs on both are aligned.

STEP 4: Place the ring-shaped flange onto the kibbeh attachment, making sure that the rims on both are aligned.

STEP 5: Replace the fixing ring onto the grinding head and twist in a clockwise direction until secure.

Using the Food Grinder

STEP 1: Place the food grinder onto a stable surface, at a height that is comfortable for the user. Make sure the power button is at the 'OFF' position and then plug in, and switch on main power supply.

STEP 2: Place a suitable clean container beneath the grinding head to catch food.

STEP 3: Turn on the food grinder by pressing the power button.

STEP 4: Place the food to be ground into the hopper plate. Using the pusher, push the food gently into the feeding tube. Do not apply excessive pressure.

Note: For better results, cut meat into cubes or stripes.

Make sure frozen meat is defrosted thoroughly.

Warning: Max. operation time is 5 minutes. After 5 minutes of continuous use, allow the food grinder to cool for 15 minutes before using again.

Only use the supplied pusher to push meat into the feeding tube.

Using Screw Reverse (R) Mode

Screw reverse mode (R) can be used to reverse any blockages that occur during the grinding process.

STEP 1: Turn off the food grinder by pressing the power button.

STEP 2: Wait until the feed screw stops rotating. Select the reverse function by pressing and holding the function button until the blockage is cleared.

Note: Make sure the function button is at position '0' before activating the 'R' function. Failure to do so will result in the reverse function not working.

PROGRESS®

Est. 1931

Storage

Check that the food grinder is cool, clean and dry before storing in a cool, dry place.

Keep the food grinder away from children

Never wrap the cord tightly around the food grinder; wrap it loosely to avoid causing damage.

Carefully store the blades to avoid injury.

Specifications

Product code: EK4380PVDEEU7

Input: 220–240 V ~ 50/60 Hz

Rated Power: 800 W

Locked power: 2000–2200 W

**UP Global Sourcing UK Ltd.,
UK. Manchester OL9 0DD.
Germany. 51149 Köln.**

If this product does not reach you in an acceptable condition please contact our Customer Services Department at **www.progresscookshop.com**.

Please have your delivery note to hand as details from it will be required. If you wish to return this product, please return it to the retailer from where it was purchased with your receipt (subject to their terms and conditions).

Guarantee

All products purchased as new carry a manufacturer's guarantee; the time period of the guarantee will vary dependent upon the product. Where reasonable proof of purchase can be provided, Progress will provide a standard 12 month guarantee with the retailer from the date of purchase. This is only applicable when products have been used as instructed for their intended, domestic use. Any misuse or dismantling of products will invalidate any guarantee.

Under the guarantee, we undertake to repair or replace free of any charge any parts found to be defective. In the event that we cannot provide an exact replacement, a similar product will be offered or the cost refunded. Any damages from daily wear and tear are not covered by this guarantee, nor are consumables such as plugs, fuses etc.

Please note that the above terms and conditions may be updated from time to time and we therefore recommend that you check these each time you revisit the website.

Nothing in this guarantee or in the instructions relating to this product excludes, restricts or otherwise affects your statutory rights.

The crossed out wheelie bin symbol on this item indicates that this appliance needs to be disposed of in an environmentally friendly way when it becomes of no further use or has worn out. Contact your local authority for details of where to take the item for recycling.



PROGRESS®

Est. 1931



Manufactured by:
UP Global Sourcing UK Ltd.,
UK. Manchester OL9 0DD.
Germany. 51149 Köln.

Made in China.

CD151020/MD000000/V1