

User manual

Coffee grinder

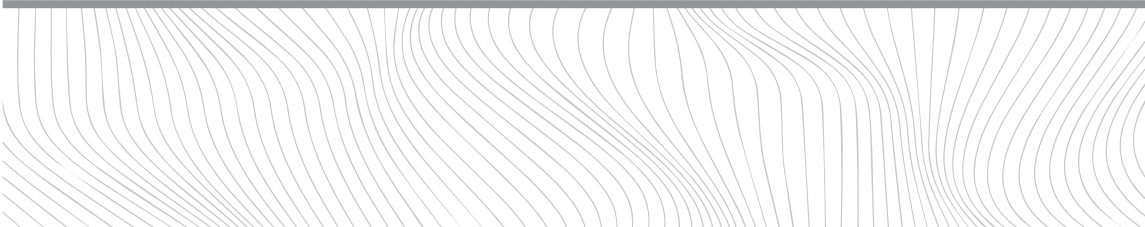

Description of parts

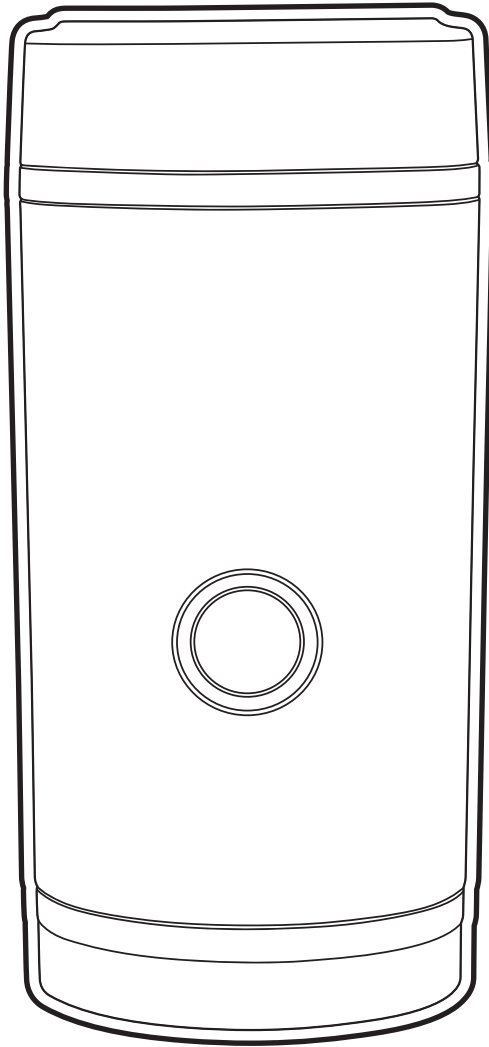
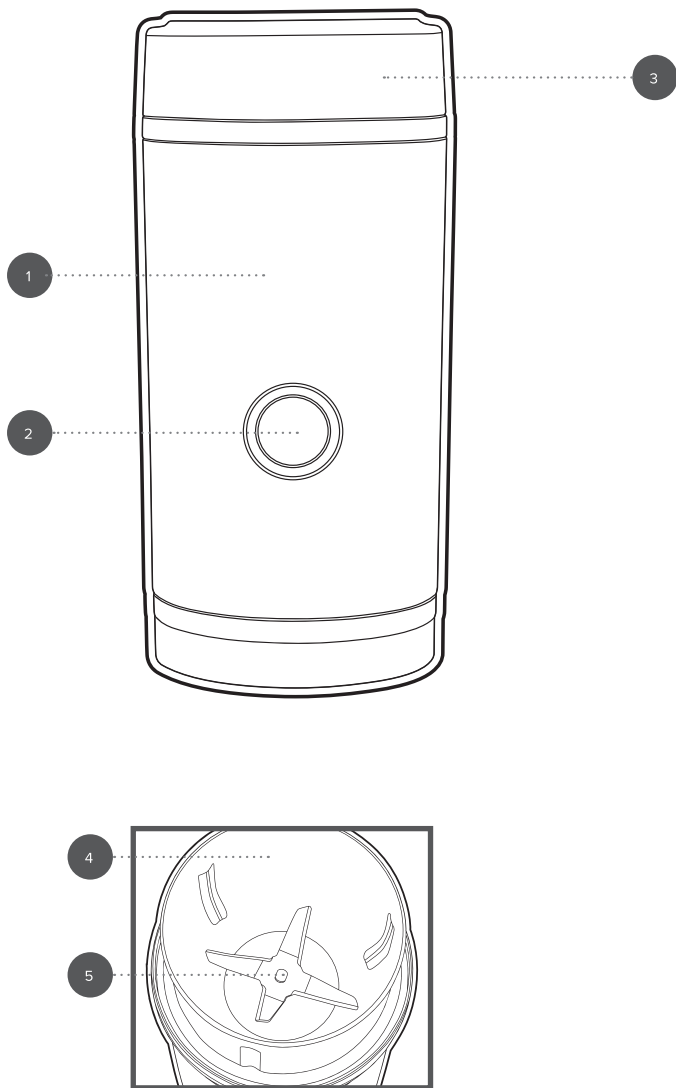

- 1. Coffee grinder base unit
- 2. Power button
- 3. Transparent lid
- 4. Bowl
- 5. Stainless steel blades

Please retain instructions for future reference.

SAFETY INSTRUCTIONS

- When using electrical appliances, basic safety precautions should always be followed.
- Check that the voltage indicated on the rating plate corresponds with that of the local network before connecting the appliance to the mains power supply.
- This appliance can be used by children aged from 8 years and above and persons with reduced physical, sensory or mental capabilities and knowledge, if they have been supervised/instructed and understand the hazards involved.
- Children shall not play with the appliance.
- Children should not perform cleaning or user maintenance, unless they are older than 8 and supervised.
- This appliance is not a toy.
- If the power supply cord, plug or any part of the appliance is malfunctioning or if it has been dropped or damaged, cease using the product immediately to avoid potential injury.
- This appliance contains no user serviceable parts, only a qualified electrician should carry out repairs. Improper repairs may place the user at risk of harm.
- Keep the appliance and its power supply cord out of the reach of children.
- Keep the appliance out of the reach of children when it is switched on or cooling down.
- Keep the appliance and its power supply cord away from heat or sharp edges that could cause damage.
- Keep the power supply cord away from any parts of the appliance that may become hot during use.
- Keep the appliance away from other heat emitting appliances.
- Do not allow the power supply cord to hang over worktops, touch hot surfaces or become twisted.
- Do not immerse the electrical components of this appliance in water or any other liquid.
- Do not operate the appliance with wet hands or if any connections are wet.
- Do not leave the appliance unattended whilst connected to the mains power supply.
- Do not remove the appliance from the mains power supply by pulling the charging cable; switch it off and remove the plug by hand.
- Do not pull or carry the appliance by its power supply cord.
- Do not use the appliance for anything other than its intended use.
- Do not use any accessories other than those supplied.
- Do not use this appliance outdoors.
- Do not store the appliance in direct sunlight or in high humidity conditions.
- Do not move the appliance whilst it is in use.

- Do not touch any sections of the appliance that may become hot during use, as this could cause injury.
- If this appliance falls or accidentally becomes immersed in water, unplug it from the wall outlet immediately. Do not reach into the water.
- Do not use broken, damaged, or loose attachments.
- Switch off the appliance and disconnect it from the mains power supply before changing or fitting attachments.
- Always unplug the appliance after use and ensure it has cooled fully before performing any cleaning, user maintenance or storing away.
- This appliance should not be operated by means of an external timer or separate remote control system, other than that supplied with this appliance.
- Use of an extension cord with the appliance is not recommended.
- Always use the appliance on a stable, heat-resistant surface, at a height that is comfortable for the user.
- This appliance is intended for domestic use only. It should not be used for commercial purposes.



CAUTION: Do not touch any moving parts on this appliance during use, as this could cause injury. Keep hands, fingers, hair and any loose clothing away from the rotating tools of the appliance.

Dos and don'ts

DO:

Check that the transparent lid is securely fitted before use; do not attempt to remove it until the blades have stopped moving.

Only grind the amount of coffee, spices or nuts required.

Clean the bowl, stainless steel blades and transparent lid after each use.

DON'T:

Leave ground coffee or spices in the bowl, as they will become stale which may affect the flavour of freshly ground ingredients.

Overfill the bowl.

Grind oily or hard ingredients such as rice.



WARNING: Do not grind for long periods of time. Never operate the coffee grinder when the bowl is empty, cracked or broken.

Care and maintenance

STEP 1: Before attempting any cleaning or maintenance, switch off and unplug the coffee grinder from the mains power supply.

STEP 2: Wipe the coffee grinder base unit with a soft, damp cloth and allow to dry thoroughly.

STEP 3: Clean the accessories in warm, soapy water, then rinse and dry thoroughly.



NOTE: Always clean the coffee grinder immediately after each use. The coffee grinder and accessories are not suitable for use in a dishwasher.



WARNING: Handle the stainless steel blade with care, as the blades are extremely sharp. Exercise caution when cleaning the stainless steel blade.

Instructions for use

Before first use



NOTE: When using the coffee grinder for the first time, a slight odour may be emitted. This is normal and will soon subside. Allow for sufficient ventilation around the coffee grinder.

Using the coffee grinder

STEP 1: Place the coffee grinder onto a flat, stable surface at a height that is comfortable for the user.

STEP 2: Remove the transparent lid from the coffee grinder base unit by rotating it in an anticlockwise direction and lifting up.

STEP 3: Add up to 70 g of coffee beans, spices or nuts to the bowl.

STEP 4: Fit the transparent lid back onto the coffee grinder base unit and twist it in a clockwise direction, ensuring the triangle and lock symbol are aligned.

STEP 5: Plug in and switch on the coffee grinder at the mains power supply.

STEP 6: Press and hold '**Power**' to begin grinding.

STEP 7: Stop the grinding process by releasing '**Power**'.

STEP 8: Once grinding is complete, switch off and unplug the coffee grinder from the mains power supply.

STEP 9: Remove the transparent lid and transfer the ground coffee, spices or nuts into a suitable container, ready for use or storage.



WARNING: Maximum operation time is approx. 40 seconds. Allow to cool for approx. 1 minute. before using the coffee grinder again.

Grinding grade	Quantity	Approx. time
Coarse (French press)	70 g (approx. 8 tbsp)	25 seconds
Medium (filter)	45 g (approx. 5 tbsp)	30 seconds
Fine (espresso)	36 g (approx. 4 tbsp)	40 seconds

Storage

Check that the coffee grinder is cool, clean and dry before reassembling, then store in a cool, dry place.

Never wrap the cord tightly around the coffee grinder; wrap it loosely to avoid causing damage.

Specifications

Product code: EK6135

Operating voltage: 220–240 V ~ 50/60 Hz

Power: 180 W



Disposal of Waste Batteries and Electrical and Electronic Equipment



This symbol on the product, its batteries or its packaging means that this product and any batteries it contains must not be disposed of with household waste. Instead, it is the user's responsibility to hand this over to an applicable collection point for the recycling of batteries and electrical and electronic equipment. This separate collection and recycling will help to conserve natural resources and prevent potential negative consequences for human health and the environment due to the possible presence of hazardous substances in batteries and electrical and electronic equipment, which could be caused by inappropriate disposal. Some retailers provide take-back services which allow the user to return exhausted equipment for appropriate disposal. **It is the user's responsibility to delete any data on electrical and electronic equipment prior to disposal.** For more information about where to drop batteries, electrical and electronic waste off, please contact the local city/municipality office, household waste disposal service, or the retailer.

Manufactured by:
Ultimate Products UK Ltd.,
Victoria Street, Manchester OL9 0DD. **UK.**
Ultimate Products Europe Ltd.,
19 Baggot Street Lower, Dublin D02 X658. **ROI.**

MADE IN CHINA.

CD120324/MD000000/V1