

Important safety

Please read carefully

Please retain instructions for future reference.

SAFETY INSTRUCTIONS

- When using electrical appliances, basic safety precautions should always be followed.
- Check that the voltage indicated on the rating plate corresponds with that of the local network before connecting the appliance to the mains power supply.
- This appliance can be used by children aged from 8 years and above and persons with reduced physical, sensory or mental capabilities and knowledge, if they have been supervised/instructed and understand the hazards involved.
- Children shall not play with the appliance.
- Children should not perform cleaning or user maintenance, unless they are older than 8 and supervised.
- This appliance is not a toy.
- If the power supply cord, plug or any part of the appliance is malfunctioning or if it has been dropped or damaged, cease using the product immediately to avoid potential injury.
- This appliance contains no user serviceable parts, only a qualified electrician should carry out repairs. Improper repairs may place the user at risk of harm.
- Keep the appliance and its power supply cord out of the reach of children.
- Keep the appliance out of the reach of children when it is switched on or cooling down.
- Keep the appliance and its power supply cord away from heat or sharp edges that could cause damage.
- Keep the power supply cord away from any parts of the appliance that may become hot during use.
- Keep the appliance away from other heat emitting appliances.
- Do not allow the power supply cord to hang over worktops, touch hot surfaces or become twisted.
- Do not immerse the electrical components of this appliance in water or any other liquid.
- Do not operate the appliance with wet hands or if any connections are wet.
- If this appliance falls or accidentally becomes immersed in water, unplug it from the wall outlet immediately. Do not reach into the water.
- Do not leave the appliance unattended whilst connected to the mains power supply.
- Do not remove the appliance from the mains power supply by pulling the cord; switch it off and remove the plug by hand.
- Do not pull or carry the appliance by its power supply cord.
- Do not use the appliance for anything other than its intended use.
- Do not use any accessories other than those supplied.
- Do not use any damaged accessories.
- Do not use this appliance outdoors.
- Do not store the appliance in direct sunlight or in high humidity conditions.
- Do not move the appliance whilst it is in use.
- Do not touch any moving parts on this appliance during use, as this could cause injury.
- Do not touch any sections of the appliance that may become hot during use, as this could cause injury.
- Always unplug the appliance after use and ensure it has cooled fully before any cleaning, user maintenance or storing away.
- Always use the appliance on a stable, heat-resistant surface, at a height that is comfortable for the user.
- Use of an extension cord with the appliance is not recommended.
- This appliance should not be operated by means of an external timer or separate remote control system.
- This appliance is intended for domestic use only. It should not be used for commercial purposes.



CAUTION: Keep hands, fingers, hair and any loose clothing away from the rotating tools of the appliance.



WARNING: Do not touch sharp blades.

User manual

Blender

Problem	Possible cause	Solution
The drink is watery and lacking flavour.	The ingredients have been over-blended.	Use the blender to pulse blend ingredients in short bursts for the best results.
The blending cup is leaking.	The lid is not correctly secured to the blending cup.	Checking that the threads are correctly aligned, twist the lid in a clockwise direction until it is secure.
The ingredients do not blend well.	The ingredients may need readjusting.	Use the blender to pulse blend ingredients in short bursts for the best results. For frozen ingredients, pulse blend in short bursts of approx. 2–5 seconds.

Storage

Reassemble the blender.

Check that the blender is cool, clean and dry before storing in a cool, dry place.

Never wrap the cord tightly around the blender; wrap it loosely to avoid causing damage.

Specifications

Product code: EK2435

Operating voltage: 220–240 V ~ 50–60 Hz

Power: 900 W



Manufactured by:
Ultimate Products UK Ltd.,
Victoria Street, Manchester OL9 0DD. **UK.**
Ultimate Products Europe Ltd.,
19 Baggot Street Lower, Dublin D02 X658. **ROI.**

MADE IN CHINA.

CD170425/MD000000/V1

Description of parts

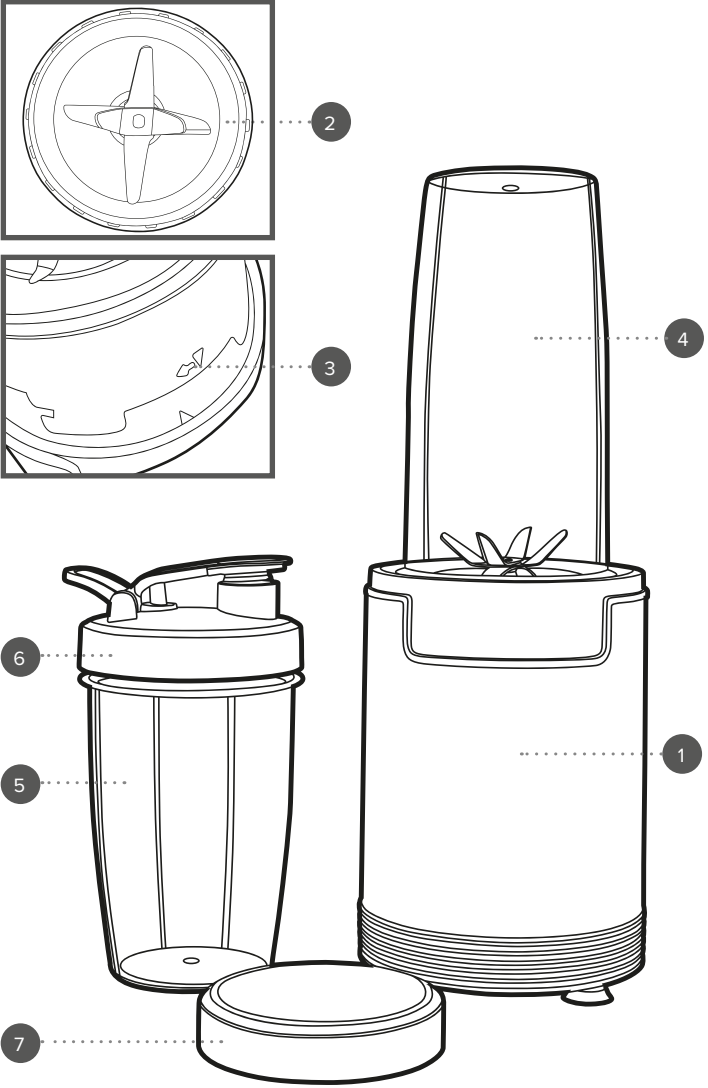

- 1. Blender base unit
- 2. Six-blade lid attachment
- 3. Alignment arrows
- 4. Large blending cup (975 ml)
- 5. Small blending cup (740 ml)
- 6. Easy-drink lid
- 7. Storage lid

Please retain instructions for future reference.

Dos and don'ts

DO:
 Switch off the blender and disconnect it from the mains power supply before changing or fitting attachments.
 Check that the blade attachment is securely fitted before use.
 Chop all ingredients into small pieces before blending.
 Add a small amount of cold liquid or reduce the quantity of the ingredients in the plastic blending cup if the blades are not running smoothly.
 Remove the plastic blending cup from the blender base unit and shake to redistribute the ingredients if they do not blend evenly, then blend once more.
 Exercise caution when handling the blade attachment, as the blades may get hot during use.
 Take care when removing the blade attachment, as pressure build-up could cause the contents of the blender to spill if blending warm ingredients.

DO NOT:
 Dry blend ingredients; always add a small amount of liquid.
 Use attachments or cutting/rotating blades if they are loose, damaged or broken.
 Operate the blender if the blending cup is cracked, broken or empty.
 Exceed the max. fill mark when adding ingredients to the blending cup, as this could cause spillage and may damage the blender.

Care and maintenance

STEP 1: Switch off and unplug the blender from the mains power supply before performing any cleaning or user maintenance.
STEP 2: Wipe the blender base unit with a soft, damp cloth and allow to dry thoroughly.
STEP 3: To clean the blending cups, either rinse under a tap, or add soapy water and blend for 30 seconds.
STEP 4: Empty the water, fill again with fresh water and repeat until clean.
 Never touch the blades; using extreme caution, clean the blade with a brush and dry carefully.
 Never immerse the blender base unit or the underside of the six-blade lid attachment in water or any other liquid.

NOTE: Always clean the blender immediately after each use. Do not use harsh or abrasive scourers to clean the blender, as this could cause damage. The blender and accessories, including the six blade lid attachment, are not suitable for use in a dishwasher.

WARNING: Handle the six-blade lid attachment with care, as the blades are sharp. Exercise caution when attaching, removing, cleaning or storing the attachments.

Instructions for use

Before first use

Before connecting to the mains power supply, clean the blender following the instructions in the section entitled '**Care and maintenance**'.

NOTE: When using the blender for the first time, a slight odour may be emitted. This is normal and will soon subside. Allow for sufficient ventilation around the blender.

Using the blender

STEP 1: Position the blender base unit onto a flat, stable surface, at a height that is comfortable for the user.

STEP 2: Place the ingredients into the blending cup, making sure that they do not exceed the max. fill mark.

STEP 3: Pour a small amount of liquid into the blending cup; this will help to blend the ingredients.

STEP 4: Secure the six-blade lid attachment onto the blending cup by twisting it in a clockwise direction.

STEP 5: Plug in and switch on the blender at the mains power supply.

STEP 6: Invert the blending cup so that the six-blade lid attachment is facing downwards, align the arrows on the blade attachment and base unit and then twist the blending cup clockwise.

STEP 7: To stop blending, twist the blending cup in an anticlockwise direction and lift it up and away from the blender base unit.

STEP 8: Switch off and unplug the blender from the mains power supply.

STEP 9: Remove the six-blade lid attachment by twisting it in an anticlockwise direction and then replace it with the easy-drink lid if required.



NOTE: It is important that the arrows on the blade attachment and base unit are aligned before twisting the blending cup in a clockwise direction because the blender will not operate if this is not fitted correctly.



WARNING: Do not blend warm or hot liquid or food, as this may cause a pressure build-up and, in turn, serious injury. Max. operation time is 1 minute; allow the blender to cool for 3 minutes before using it again. Using the blender for longer than 1 minute at a time will cause the temperature to increase, which may lead to a pressure build-up. If this happens, switch off and unplug the blender from the mains power supply and allow it to cool thoroughly before attempting to remove the six-blade lid attachment. Do not immerse the blending cup in cold water at this time.

Troubleshooting

Problem	Possible cause	Solution
The blender will not operate.	The blender is not connected to the mains power supply.	Plug in and switch on the blender at the mains power supply.
	The six-blade lid attachment is not correctly secured to the blending cup.	Checking that the threads are correctly aligned, twist the six-blade lid attachment in a clockwise direction until it is secure.
	The six-blade attachment is not correctly secured to the main unit.	Ensure the arrows on the six-blade attachment and the arrows on the main unit are aligned before twisting the blending cup clockwise.
The drink contains lumps.	There are too many ingredients in the blending cup.	Reduce the amount of ingredients in the blending cup.