

Important safety

Please read carefully

Please retain instructions for future reference.

SAFETY INSTRUCTIONS

- When using electrical appliances, basic safety precautions should always be followed.
- Check that the voltage indicated on the rating plate corresponds with that of the local network before connecting the appliance to the mains power supply.
- This appliance can be used by children aged from 8 years and above and persons with reduced physical, sensory or mental capabilities and knowledge, if they have been supervised/instructed and understand the hazards involved.
- Children shall not play with the appliance.
- Children should not perform cleaning or user maintenance, unless they are older than 8 and supervised.
- This appliance is not a toy.
- If the power supply cord, plug or any part of the appliance is malfunctioning or if it has been dropped or damaged, cease using the product immediately to avoid potential injury.
- This appliance contains no user serviceable parts, only a qualified electrician should carry out repairs. Improper repairs may place the user at risk of harm.
- Keep the appliance and its power supply cord out of the reach of children.
- Keep the appliance out of the reach of children when it is switched on or cooling down.
- Keep the appliance and its power supply cord away from heat or sharp edges that could cause damage.
- Keep the power supply cord away from any parts of the appliance that may become hot during use.
- Keep the appliance away from other heat emitting appliances.
- Do not allow the power supply cord to hang over worktops, touch hot surfaces or become twisted.
- Do not immerse the electrical components of this appliance in water or any other liquid.
- Do not operate the appliance with wet hands or if any connections are wet.
- If this appliance falls or accidentally becomes immersed in water, unplug it from the wall outlet immediately. Do not reach into the water.
- Do not leave the appliance unattended whilst connected to the mains power supply.
- Do not remove the appliance from the mains power supply by pulling the cord; switch it off and remove the plug by hand.
- Do not pull or carry the appliance by its power supply cord.
- Do not use the appliance for anything other than its intended use.
- Do not use any accessories other than those supplied.
- Do not use any damaged accessories.
- Do not use this appliance outdoors.
- Do not store the appliance in direct sunlight or in high humidity conditions.
- Do not move the appliance whilst it is in use.
- Do not touch any moving parts on this appliance during use, as this could cause injury.
- Do not touch any sections of the appliance that may become hot during use, as this could cause injury.
- Always unplug the appliance after use and ensure it has cooled fully before any cleaning, user maintenance or storing away.
- Always use the appliance on a stable, heat-resistant surface, at a height that is comfortable for the user.
- Use of an extension cord with the appliance is not recommended.
- This appliance should not be operated by means of an external timer or separate remote control system.
- This appliance is intended for domestic use only. It should not be used for commercial purposes.



CAUTION: Keep hands, fingers, hair and any loose clothing away from the rotating tools of the appliance.



WARNING: Do not touch sharp blades.

and turning in a clockwise direction until securely attached.

Using the chopper

- STEP 1:** Position the blender base unit onto a flat, stable surface at a height that is comfortable for the user.
- STEP 2:** Chop the ingredients to be blended into small pieces – no bigger than 2 cm x 2 cm - and then place them into the chopping cup. Make sure they do not exceed the 450 ml fill mark.
- STEP 3:** Carefully push the chopping blade onto the chopping attachment until firmly secured.
- STEP 4:** Fit the chopping attachment on to the chopping cup and turn the chopping attachment in a clockwise direction so it locks into place.
- STEP 5:** Fit the chopping cup onto the main base unit and turn the chopping cup in a clockwise direction so it locks into place.
- STEP 6:** Plug in and switch on the blender at the mains power supply.
- STEP 7:** To chop the ingredients, turn the control dial to the desired speed setting ('1', '2'). Turn the dial to the 'P' position to activate pulse function, release to stop it. The pulse function provides quick bursts of speed useful for more solid foods.
- STEP 8:** Stop the chopping process by turning the control dial to the '0' position.
- STEP 9:** Switch off and unplug the blender from the mains power supply.
- STEP 10:** Detach the chopping cup from the blender base unit by turning the chopping in an anticlockwise direction and lifting it up and away from blender base unit.

Troubleshooting

Problem	Solution
The blender will not operate.	Ensure the blender is plugged into the mains power supply.
	The thermal overheat protection may have kicked in. Turn the blender off at the mains power supply, remove some of the ingredients and wait for approx. 30 minutes before reusing.
	Check the fuse is in working order and does not need to be replaced.
The drink contains lumps or has not blended well.	Reduce the amount of solid ingredients in the jug and/or add more liquid ingredients. Use the pulse function in short burst for harder ingredients and ice.
The drink is watery and lacking flavour.	Ingredients may have been over-blended. Use the pulse function in short bursts.

Storage

Reassemble the blender.

Check that the blender is cool, clean and dry before storing in a cool, dry place.

Never wrap the cord tightly around the blender; wrap it loosely to avoid causing damage.

Specifications

Product code: EK6694

Input: 220–240 V ~ 50/60 Hz

Output: 500 W

Maximum operation time: 1 minute, cool for 1 minute

Power consumption (off mode): 0.1 W

User manual

Blender

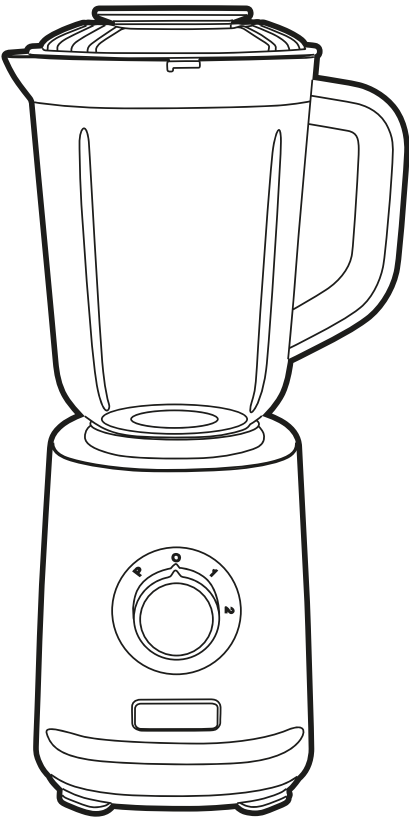

To register for your extended guarantee, scan the QR code or visit guarantee.upplc.com/progress and register your product within 30 days of purchase. For any further queries, visit www.progresscookshop.com.

Manufactured by:
Ultimate Products UK Ltd.,
Victoria Street, Manchester OL9 0DD. **UK.**
Ultimate Products Europe Ltd.,
19 Baggot Street Lower, Dublin D02 X658. **ROI.**

MADE IN CHINA.

©Progress trademark. All rights reserved.
CD010525/MD000000/V1



Description of parts

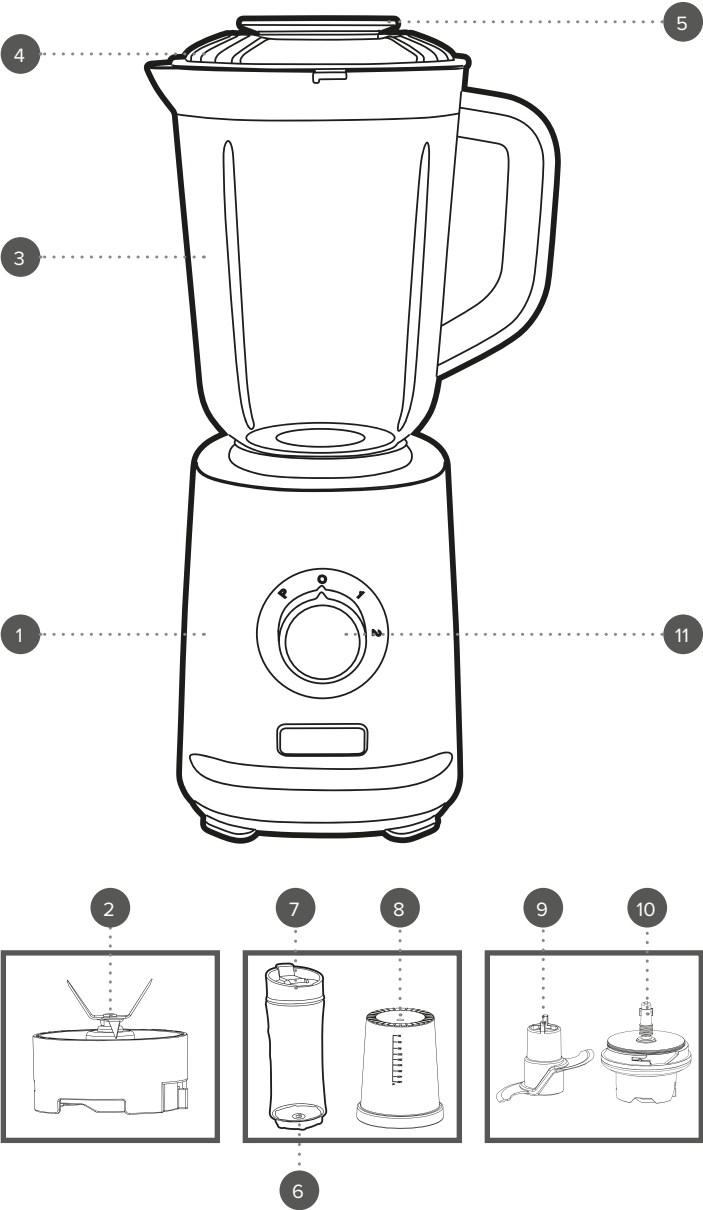

1. Blender base unit

2. Blender blade attachment

3. Jug

4. Jug lid

5. Filler cap

6. Sports bottle
7. Sports bottle lid

8. Chopping cup

9. Chopping blade

10. Chopping attachment

11. Control dial (P, 0, 1, 2)

Please retain instructions for future reference.

Dos and don'ts

DO:

Check that the blade attachment is securely fitted before use.
Chop all ingredients into small pieces before blending.
Add a small amount of cold liquid or reduce the quantity of the ingredients in the jug if the blades are not running smoothly.
If the ingredients do not blend evenly, remove the jug, chopper or sports bottle from the blender base unit. Shake the jug to redistribute the ingredients and then blend once more.

Exercise caution when handling the blade attachment, as the blades may get hot during use. If blending warm ingredients, take care when removing the blade attachment, as pressure-build up could cause the contents of the blender to spill.

DO NOT:

Attempt to remove the blade attachment until the blades have fully stopped moving.
Blend dry ingredients for more than 60 seconds at a time.
Dry blend ice cubes (blend without sufficient liquid).
Blend hot liquid or food.
Exceed the max. fill mark.
Clean the jug with boiling water.

Care and maintenance

STEP 1: Switch off and unplug the blender from the mains power supply before performing any cleaning or user maintenance.
STEP 2: Wipe the blender base unit with a soft, damp cloth and allow to dry thoroughly.
STEP 3: To disassemble the blade attachment for cleaning, place the jug on a flat surface and turn by hand in an anticlockwise direction. This will separate the base and blades from the jug or sports bottle.
STEP 4: With the blade attachment removed, wash the jug or sports bottle in warm, soapy water, then rinse and dry thoroughly.
Never touch the blades; using extreme caution, wash the blade attachment with a brush or sponge under a running tap and allow to air dry.
STEP 5: To replace the blade attachment, turn by hand in a clockwise direction until securely in position.
Never use harsh or abrasive detergents or scourers to clean the blender, as this could cause damage.



NOTE: The blade attachment is provided fully assembled. Always clean the blender immediately after each use. The blender is not suitable for use in a dishwasher.



WARNING: Handle the blade attachment with care, as the blades are extremely sharp. Exercise caution when attaching, removing, cleaning or storing the blade attachment.

Instructions for use

Before first use

STEP 1: Before connecting to the mains power supply, clean blender following the instructions in the section entitled 'Care and maintenance'.



NOTE: When using the blender for the first time, a slight smoke or odour may be emitted. This is normal and will soon subside. Allow for sufficient ventilation around the blender.

Using the blender

STEP 1: Position the blender base unit onto a flat, stable surface at a height that is comfortable for the user.
STEP 2: Place the jug on top of the blender base unit and lock into place by twisting in a clockwise direction.
STEP 3: Chop the ingredients to be blended into small pieces and then place them into the jug, making sure they do not exceed the max. fill mark.
STEP 4: Pour the required amount of liquid into the jug, making sure it does not exceed the max. fill mark. The filler cap can be used as a small measuring cup.
STEP 5: Fit the jug lid and filler cap on the jug. Fit the jug onto the blender base unit and turn in a clockwise direction until it locks into place. Plug in and switch on the blender at the mains power supply.
STEP 6: To blend the ingredients, turn the control dial to the desired speed setting ('1', '2'). Turn the dial to 'P' to activate the pulse function; release to stop it. The pulse function provides quick bursts of speed, useful for more solid foods.
STEP 7: Stop the blending process by turning the control dial to '0'.
STEP 8: Switch off and unplug the blender from the mains power supply.
STEP 9: Detach the jug from the blender base unit by twisting in an anticlockwise direction and pulling it away from blender base unit.



NOTE: The blender will not operate if the jug blender is not correctly locked into place. Ensure all tabs are aligned and locked before use. Do not operate the blender unless the lid is securely attached. Ingredients can be added whilst the blender is in operation via the filler cap. Twist the filler cap in an anticlockwise direction to remove it. When mixing liquid, use a tall container or blend small quantities at a time to reduce spillage and splattering. The blender is fitted with a thermal overheat protection. If the blender gets too hot, it will cut out. To continue, switch the blender off at the mains power supply, remove some of the foodstuffs and wait for approx. 30 minutes before continuing.



WARNING: Maximum operation time is approx. 1 minute. Allow to cool for approx. 1 minute before using the blender again.

Using the sports bottle attachment

STEP 1: Position the blender base unit onto a flat, stable surface at a height that is comfortable for the user.
STEP 2: Chop the ingredients to be blended into small pieces – no bigger than 2 cm x 2 cm - and then place them into the sports bottle.
STEP 3: Pour the required amount of liquid into the jug.
STEP 4: Fit the blade attachment onto the top of the sports bottle and turn in a clockwise direction so it locks into place.
STEP 5: Fit the sports bottle onto the main base unit and turn the sports bottle in a clockwise direction so it locks into place.
STEP 6: Plug in and switch on the blender at the mains power supply.
STEP 7: To blend the ingredients, turn the control dial to the desired speed setting ('1', '2'). Turn the dial to the 'P' position to activate pulse function, release to stop it. The pulse function provides quick bursts of speed useful for more solid foods.
STEP 8: Stop the blending process by turning the control dial to the '0' position.
STEP 9: Switch off and unplug the blender from the mains power supply.
STEP 10: Detach the sports bottle from the blender base unit by turning the sports bottle in an anticlockwise direction and lifting it up and away from blender base unit.
STEP 11: Remove the blade attachment by turning in an anticlockwise direction. The sports bottle can now be attached by positioning the lid on the sports bottle